

Optical Fiber Cable Distribution Box - FSC013 Technical Specification

Overview

DRAKO Model No. FSC013 is one of the main equipment for user access points, applied for protective connection and distribution between two or more cables. The primary function is to connect distribution cable and indoor cable in the open air. It's widely used in communication systems, cable TV, optical cable network systems and others by virtue of steady structure, good sealing performance and easy construction.

Technical Index



Model No.	FSC013
Capacity	96 cores
Material	PC+ABS,PP
Dimension(MM)	465*190*120
Inlet cable port	Φ25
Color	Black
Protection Level	IP68
Inlet/outlet	2+2
Sealing Method For Inlets	Screw mechanical
Outlet cable port	Φ25

The dimension diagram: (mm)

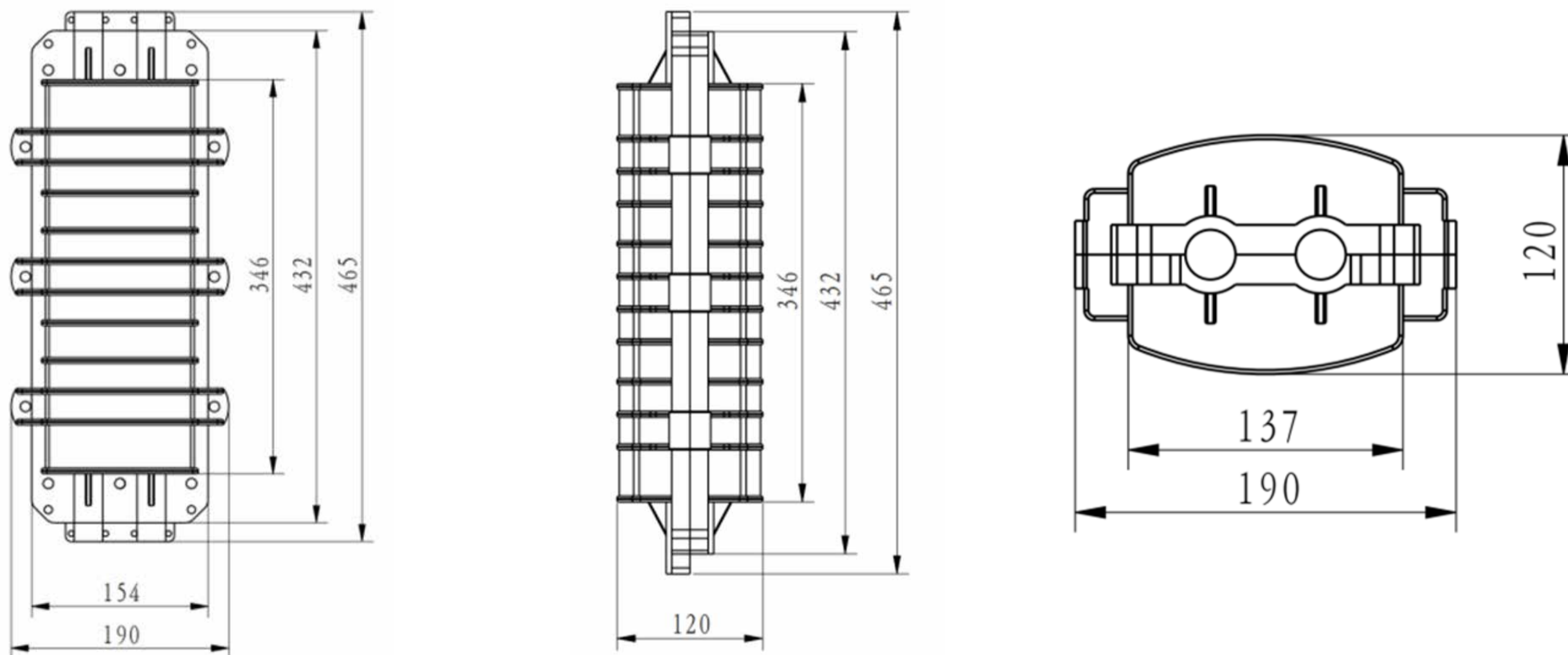

Features

- * The body is made of high quality engineering plastic with good strength;
- * With good waterproof design, the fiber optical splice closure can be applied into underground and aerial.
- * Be equipped with 4 splice trays (each capacity is 24 cores) .



- * Excellent fiber routing design ensures the radius curvature of the fiber well and enough fiber storage space.

Package Information

- 1 - Plastic bag size: 650*350mm
- 2 - Inner box with single corrugated size: 470*205*135mm
- 3 - Carton with double corrugated size: 690*485*425mm(10PCS/Box)
- 4 - Weight per carton: 25 KG